

LIFTING PLAN – SELF BUNDED TANKS

Recommendations for lifting SELF BUNDED Industrial Tanks.

- SELF BUNDED Tanks will only be despatched on their bases, and will be transported on a pallet.
- The tank/s will be fitted with M12 S/Steel D-Shackles to all MOULDED lifting lugs.
 - These Moulded Lugs are **ONLY** intended for securing the tank to the pallet and truck for transport, **DO NOT** lift the tank using the moulded lifting lugs.
- **ONLY USE** the Lifting Lugs that have been welded to the tank walls and/or Cabinet.
- A spreader bar arrangement should always be used, so that the slings are vertical. See **example** below.
- We recommend using lifting slings that are rated to at least 1000kg.
- Guide ropes are recommended to assist with moving & stabilization.
- **Plan the lift before commencing & follow your prescribed SWMS/SOP's etc.**

Untie the tank from the pallet and attach the straps to spreader bar and lifting lugs. Gently raise the tank off the truck bed, being mindful of any fittings on the tank or any adjacent tanks. Move the tank to an area with enough level ground to accommodate the tank. You may find this easier with the use of guide ropes.

DO NOT keep the tank suspended for long periods of time.

THESE ARE GENERAL RECOMMENDATIONS ONLY AND MAY NOT COVER ALL ASPECTS OF THE UNLOADING PROCEDURE.

FOLLOW ALL OF YOUR PRESCRIBED SWMS/SOP's.



NO CENTRE POINT LIFT



SPREADER BAR IS AN EXAMPLE ONLY

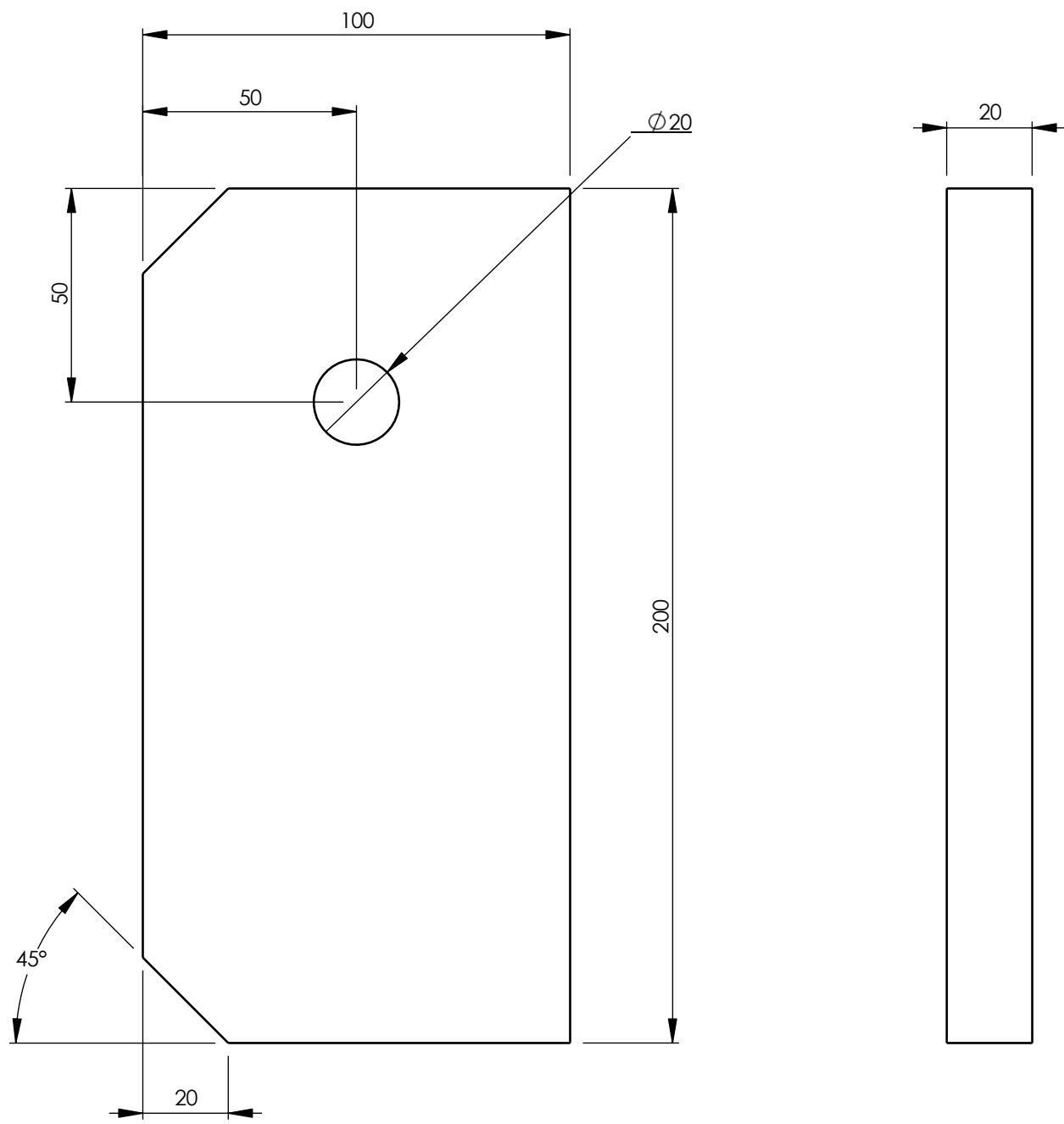

TOLERANCES (UNLESS OTHERWISE STATED)			
OVER - TO	±	±	±
0-6	0,1	0,2	0,5
6-30	0,2	0,5	1,0
30-100	0,3	0,8	1,5
100-300	0,5	1,2	2,0
300-1000	0,8	2,0	3,0
1000-3000	1,2	3,0	5,0
3000-PLUS	2,0	4,0	8,0
ANGLES	0.25°	0.5°	1°

					SCALE: 1:1.5 ON A3		DO NOT SCALE, USE DIMENSIONS. ALL DIMENSIONS ARE IN mm	MATL	HDPE	SG		WEIGHT	0 kg
							© 2015 BY POLYMASTER GROUP	TITLE	HDPE LIFTING LUG				
							CLIENT	SUB TITLE	HDPE LIFTING LUG				
REV	DRAWN	DATE	PARTICULARS	ECP No				DRAWING NO.	Bunded Station Lifting Lug	JOB NO.	HDPE	1/1	Rev: B
							DRAWN	MdH	1/02/2016				